

This map is based upon the Ordnance Survey material with the permission of the Ordnance Survey on behalf of the Controller of Her Majesty's Stationery Office. Crown copyright. Unauthorised reproduction infringes Crown copyright and may lead to prosecution or civil proceedings. Licence No. 100018385. Date 2018.

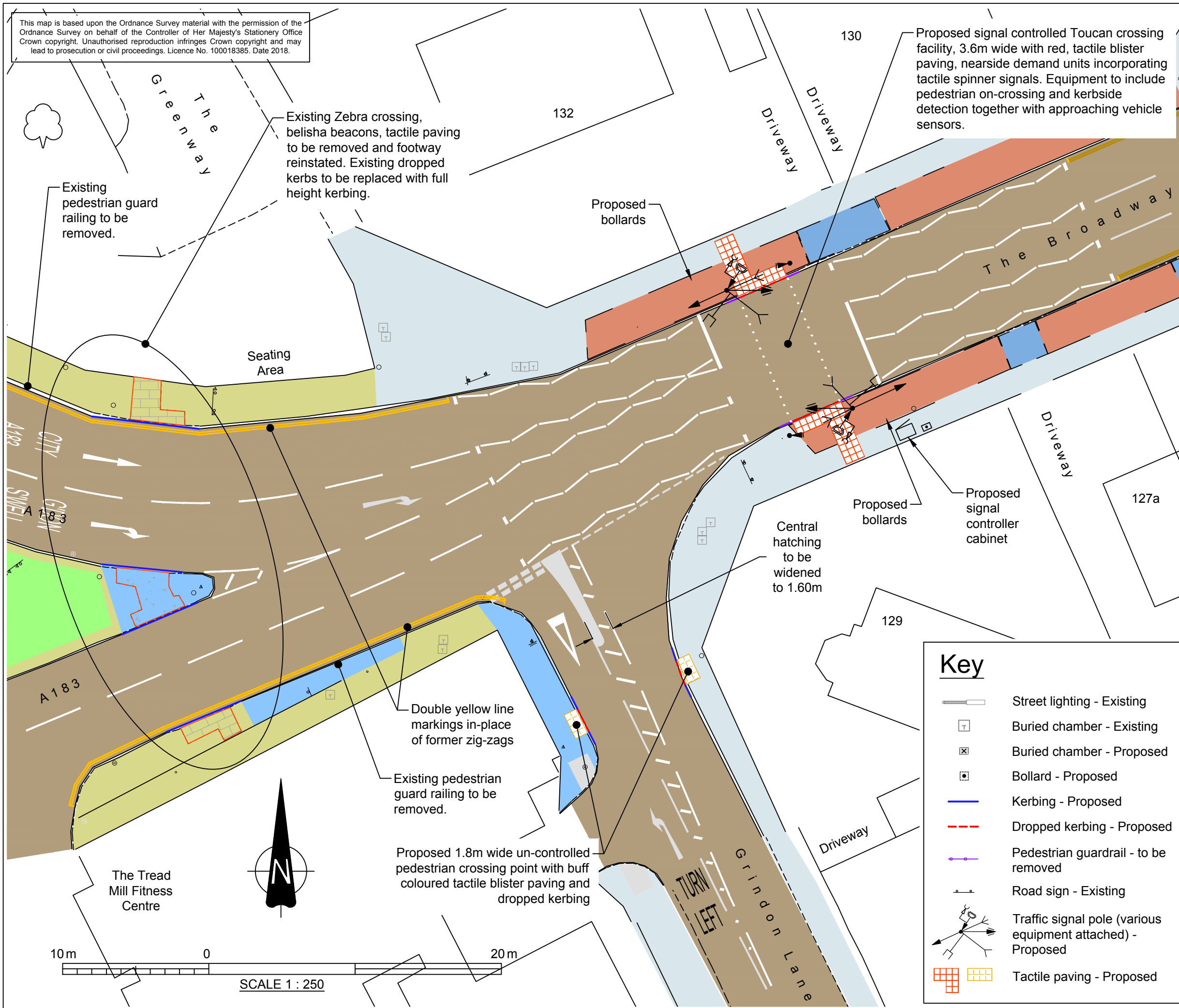

## Principal Changes

- Signal controlled Toucan crossing installed across The Broadway (A183) with dropped kerbing and tactile blister paving. Signal equipment to be low energy LED with on-crossing, kerbside and vehicle detection.
- The crossing to be re-located to the eastern side of Grindon Lane.
- Un-controlled pedestrian crossing point installed across Grindon Lane.
- Existing Zebra crossing removed and footway reinstated.
- Removal of existing pedestrian guardrail.
- Road markings changed to suit new crossing.
- Existing uncontrolled crossing points across Grindon Lane and opposite petrol filling station to be upgraded with dropped kerbs and tactile paving.
- Road safety impact of proposed changes to be monitored by Council upon completion of works.

## FOR COMMENT

REVISION	APPROVED	DESCRIPTION	DATE
B	JCW	Note added to drawing to include uncontrolled dropped crossings	22/06/18



Economy & Place  
 Jack Crawford House  
 Commercial Road  
 Sunderland SR2 8QR  
 Telephone: 0191 520 5555  
 Fax: 0191 553 1460  
 Web: www.sunderland.gov.uk

PROJECT  
**Grindon Mill Pedestrian Crossing Improvement Scheme**

TITLE  
**Public Engagement Plan**

PROJECT CONTACT		CONTACT DETAILS	
Craig Wilkinson		0191 561 1608	
DRAWN BY	BA	DATE	18/12/17
CHECKED BY	JCW	DATE	22/01/18
APPROVED BY	KSH	SIGNED	<i>[Signature]</i>
DRAWING No.			REVISION
TRS-17-0000116-010			B

### Key

- Street lighting - Existing
- Buried chamber - Existing
- Buried chamber - Proposed
- Bollard - Proposed
- Kerbing - Proposed
- Dropped kerbing - Proposed
- Pedestrian guardrail - to be removed
- Road sign - Existing
- Traffic signal pole (various equipment attached) - Proposed
- Tactile paving - Proposed