

DEPOSIT OF STATEMENT and PLAN

SECTION 31 (6) OF THE HIGHWAYS ACT 1980

To Sunderland City Council

1. I am and have been jointly since 29th July 1975 and wholly since 15th September 1988 the owner within the meaning of the above section of the land known as Offerton Grange Farm more particularly delineated on the plan accompanying this statement and thereon edged red.
2. The aforementioned land lies in the Parishes of
- * 3. ~~The ways coloured blue on the said plan have been dedicated as highways with vehicular status.~~
- * 4. The ways coloured green on the said plan have been dedicated as bridleways.
- * 5. The ways coloured yellow on the said plan have been dedicated as footpaths.
- * 6. No ways over the land have been dedicated as highways.
7. The deposit shall comprise this statement and accompanying plan.

* Delete as applicable.

LANDOWNER

Signed:

Signed:

Name:

ALLAN COXON

Name:

Address: OFFERTON GRANGE FARM

Date:

SUNDERLAND
6th July 2000

Date:

WITNESS

Signed:

Name:

S COXON

Address: Offerton Grange Farm, Offerton Village Sunderland.

Occupation:

Housewife

This plan is for identification purposes only. Its accuracy can in no way be guaranteed.
Reproduced from the Ordnance Survey Map with permission of the Controller H.M.S.O.
Crown copyright reserved.
Licence No. ES758043

OFFERTON GRANGE

SCALE: 1:5,000

Date: Jan'1998

STRUTT & PARKER

59 Newgate Street Morpeth Northumberland NE61 1AY
Telephone (01670) 516123 Facsimile (01670) 518059
E-Mail: morpeth@struttandparker.co.uk
DX 62508 Morpeth

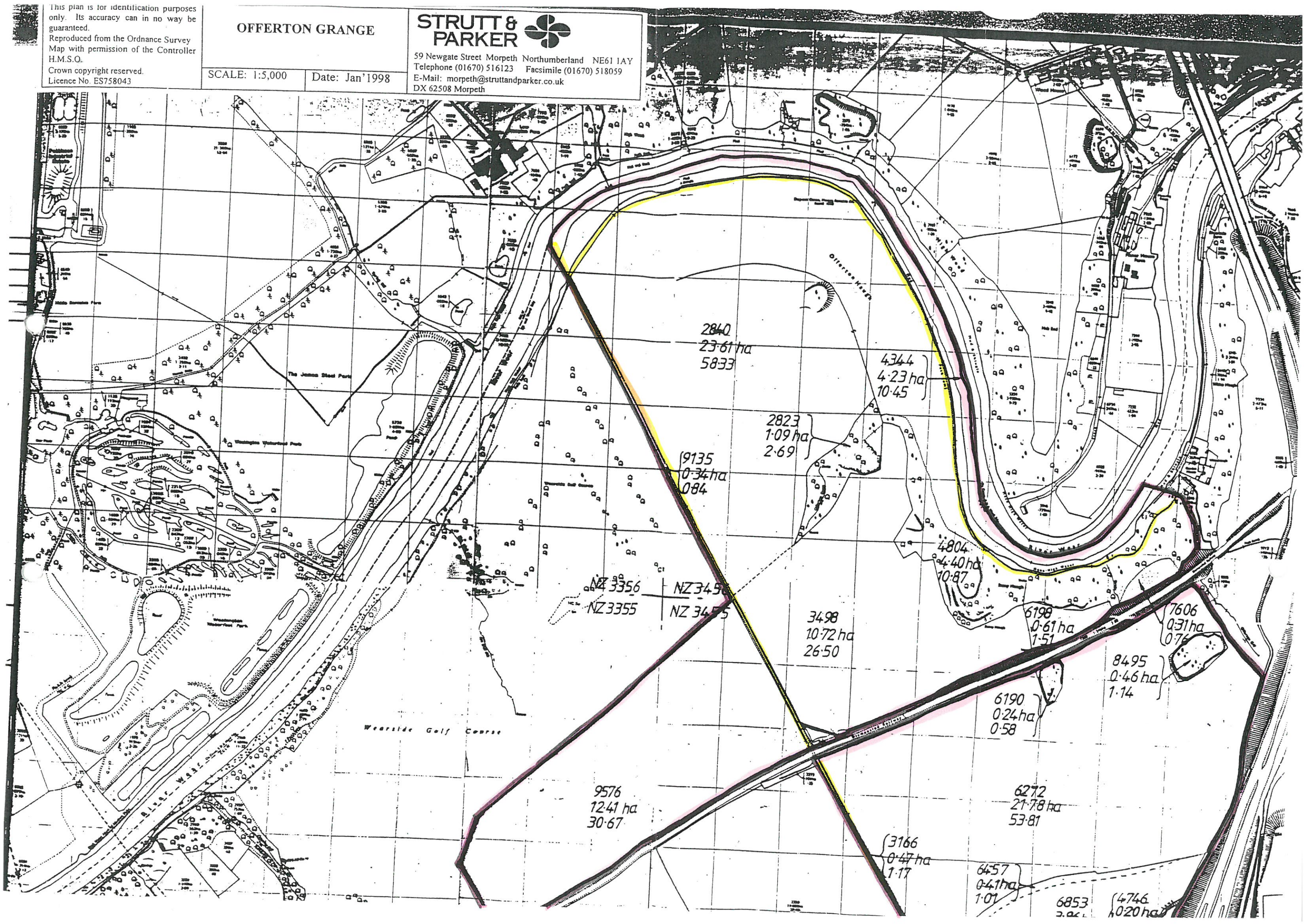

This plan is for identification purposes only. Its accuracy can in no way be guaranteed.
Reproduced from the Ordnance Survey Map with permission of the Controller H.M.S.O.
Crown copyright reserved.
Licence No. ES758043

OFFERTON GRANGE

SCALE: 1:5,000

Date: Jan'1998

STRUTT & PARKER

59 Newgate Street Morpeth Northumberland NE61 1AY
Telephone (01670) 516123 Facsimile (01670) 518059
E-Mail: morpeth@struttandparker.co.uk
DX 62508 Morpeth

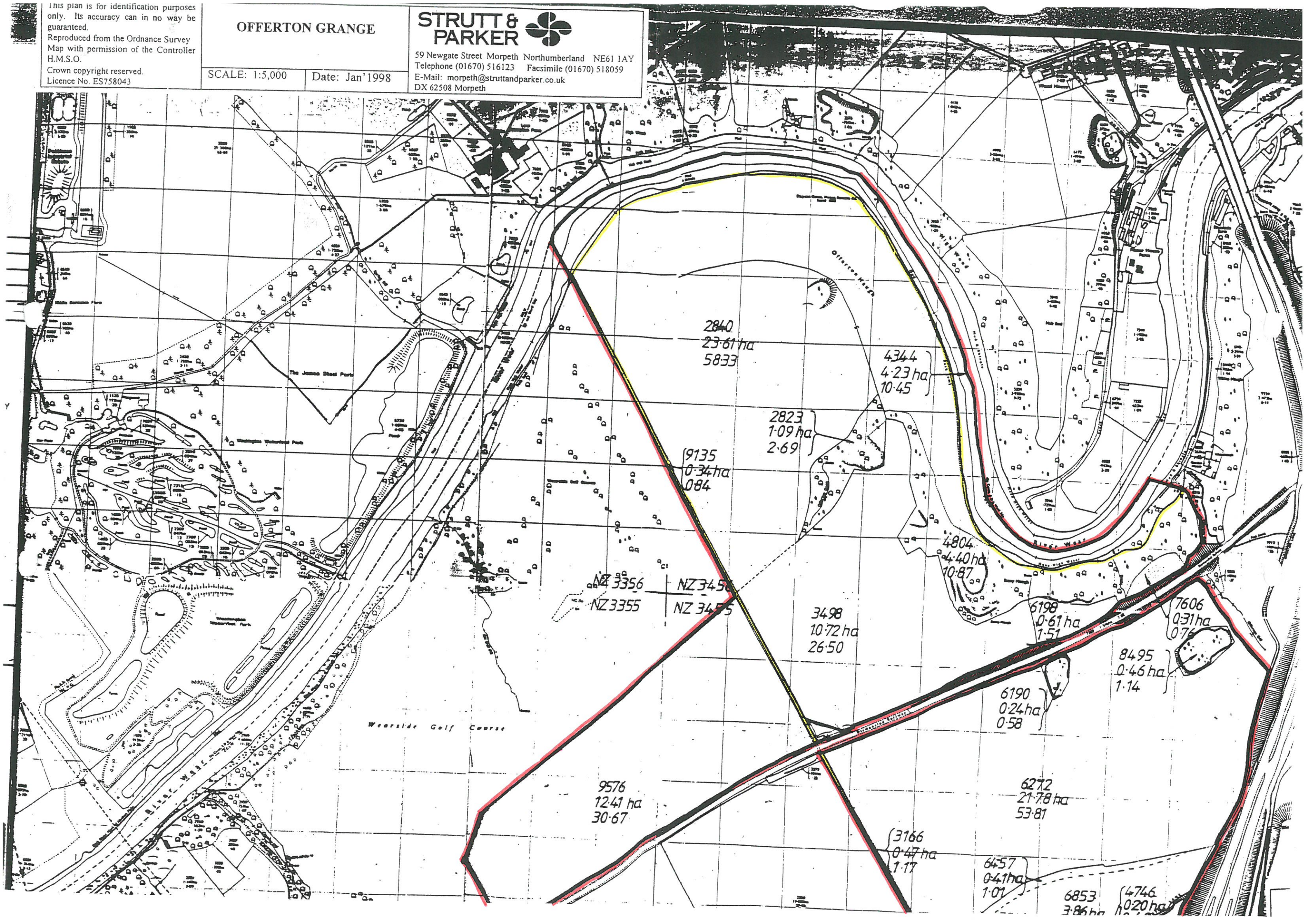

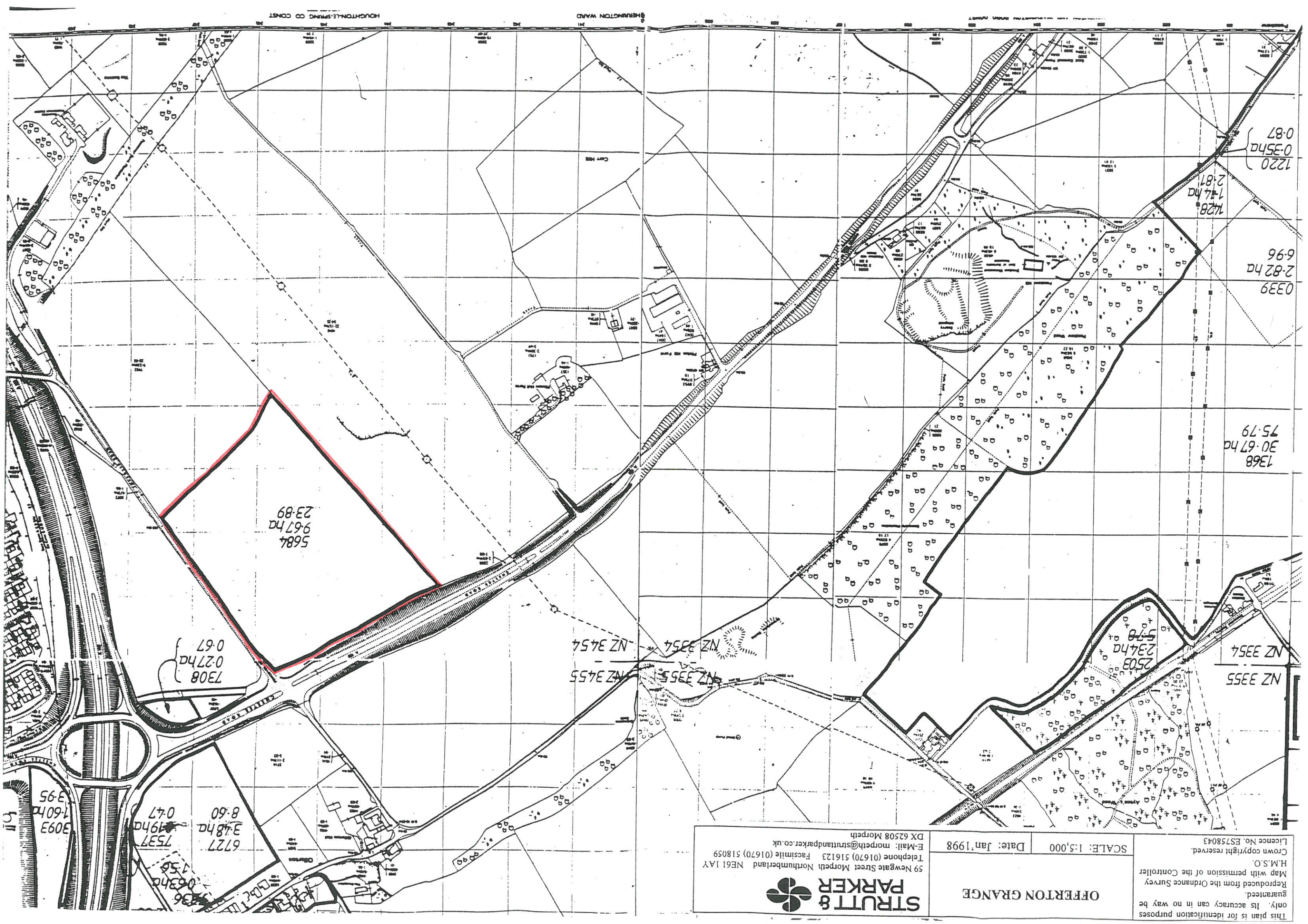

This plan is for identification purposes only. Its accuracy can in no way be guaranteed.
 Reproduced from the Ordnance Survey Map with permission of the Controller H.M.S.O.
 Crown copyright reserved.
 Licence No. ES758043

SCALE: 1:5,000
 Date: Jan 1998

STRUTT & PARKER
 59 Newgate Street Morpeth Northumberland NE61 1AY
 Telephone (01670) 516123 Facsimile (01670) 518059
 E-Mail: morpeth@struttandparker.co.uk
 DX 62508 Morpeth

1368
 30.67 ha
 75.79
 0339
 2.82 ha
 6.96
 1220
 0.35 ha
 0.87

5684
 9.67 ha
 23.89

7308
 0.27 ha
 0.67

6727
 3.48 ha
 8.60
 7537
 0.47 ha
 0.53 ha
 1.56
 3093
 1.60 ha
 3.95

NZ 3355
 NZ 3455
 NZ 3354
 NZ 3454

NZ 3355
 NZ 3354

2503
 2.34 ha
 5.78

Houghton-le-Spring Co Const
 HERRINGTON WARD

only. Its accuracy can in no way be guaranteed.
Reproduced from the Ordnance Survey Map with permission of the Controller H.M.S.O.
Crown copyright reserved.
Licence No. ES758043

OFFERTON GRANGE

SCALE: 1:5,000 Date: Jan 1998

STRUTT & PARKER

59 Newgate Street Morpeth Northumberland NE61 1AY
Telephone (01670) 516123 Facsimile (01670) 518059
E-Mail: morpeth@struttandparker.co.uk
DX 62508 Morpeth

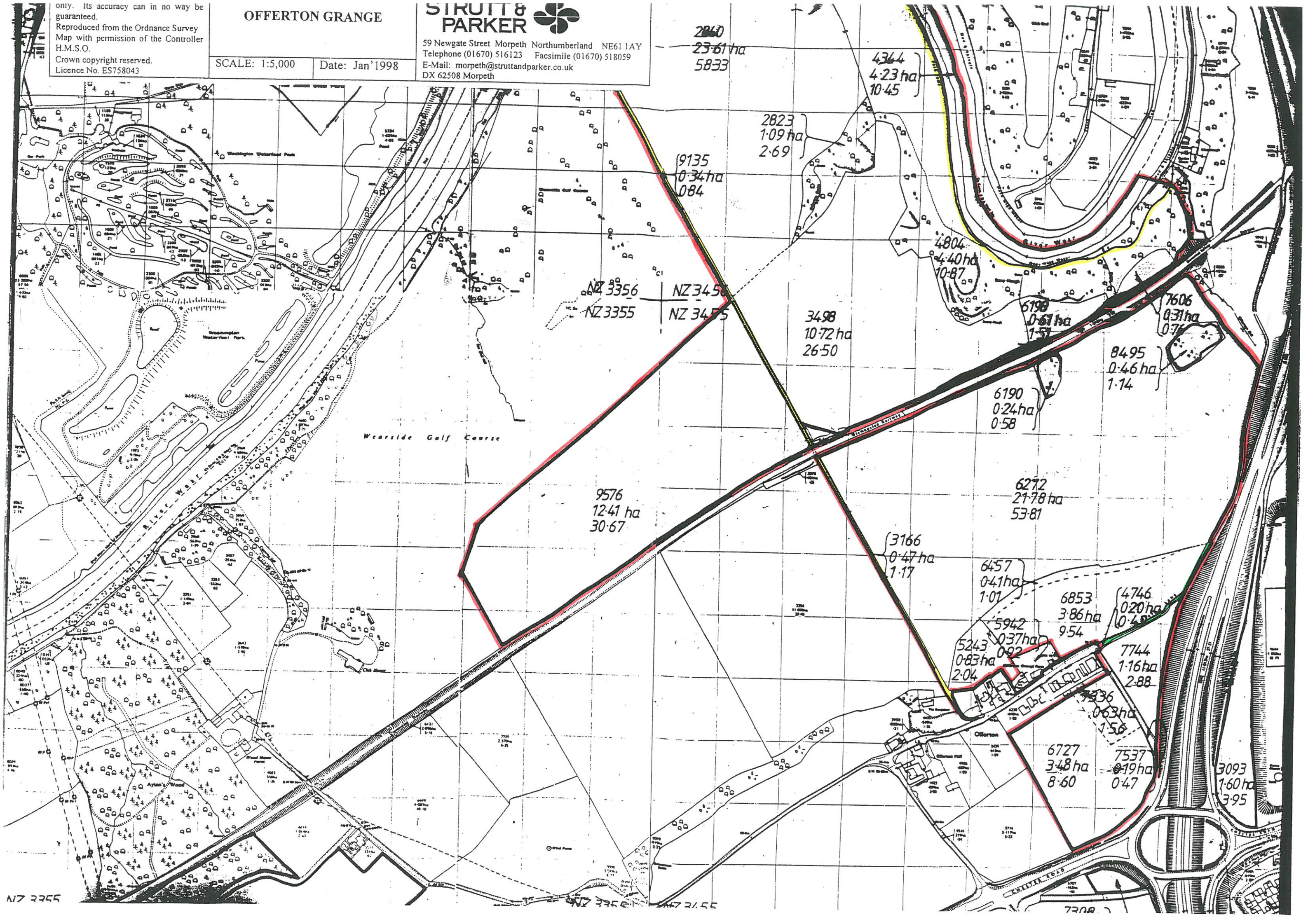

Client
A COXON

Job Title

Drawing Title
OFFERTON GRANGE

HOLDING NO. 30/763/0101

Scale **1:5,000**

Date
Drawn by
P.L. Addison FRICS, FAAV
S.S. Beeby BSc.(Hons), ARICS, FAAV

Drg. No.
Rev.

STRUTT & PARKER
59 Newgate Street Morpeth Northumberland NE61 1AY
Telephone (01670) 516123 Facsimile (01670) 518059
E-Mail: morpeth@struttandparker.co.uk
DX 62508 Morpeth

OFFERTON GRANGE

Date: Jan 1998

SCALE: 1:5,000

This plan is for identification purposes only. Its accuracy can in no way be guaranteed.
Map with permission of the Ordnance Survey H.M.S.O.
Crown copyright reserved.
Licence No. ES758043

