

**Schedule of Areas**

**Gross Internal Areas:**

<b>Main Building</b>	
• Ground Floor	76,126 m <sup>2</sup>
• First Floor	34,590 m <sup>2</sup>
• Second Floor	34,090 m <sup>2</sup>
• Central Core (First Floor)	1,832 m <sup>2</sup>
<b>Ancillary MEP Plant Rooms</b>	
• Ground Floor	2,065 m <sup>2</sup>
• Mezzanine Floor	213 m <sup>2</sup>
• First Floor	1,400 m <sup>2</sup>
• Second Floor	413 m <sup>2</sup>
• Third Floor (Stair core)	48 m <sup>2</sup>
<b>Office / QA Lab</b>	375 m <sup>2</sup>
<b>Gatehouse</b>	70 m <sup>2</sup>
<b>Pump House</b>	65 m <sup>2</sup>
<b>Total</b>	<b>151,287 m<sup>2</sup></b>

**Excluded from GIA**

- Area B Mezzanine 4,554 m<sup>2</sup>  
 (to be < max 50% of the total floor space)

*Gross Internal Area (GIA) in accordance with RICS Code of Measuring Practice 6th Edition.*

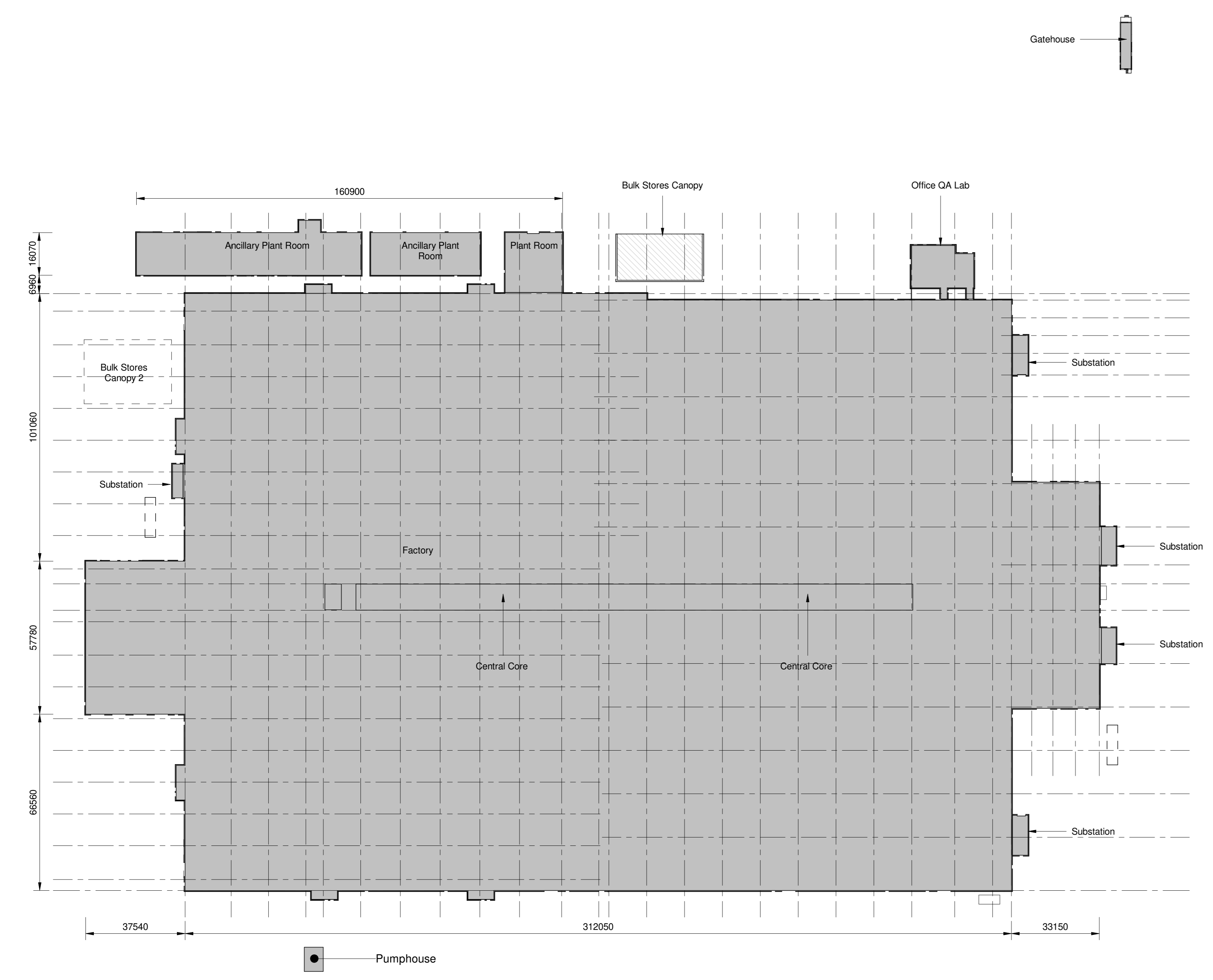

**Ground Floor**  
 1 : 1000

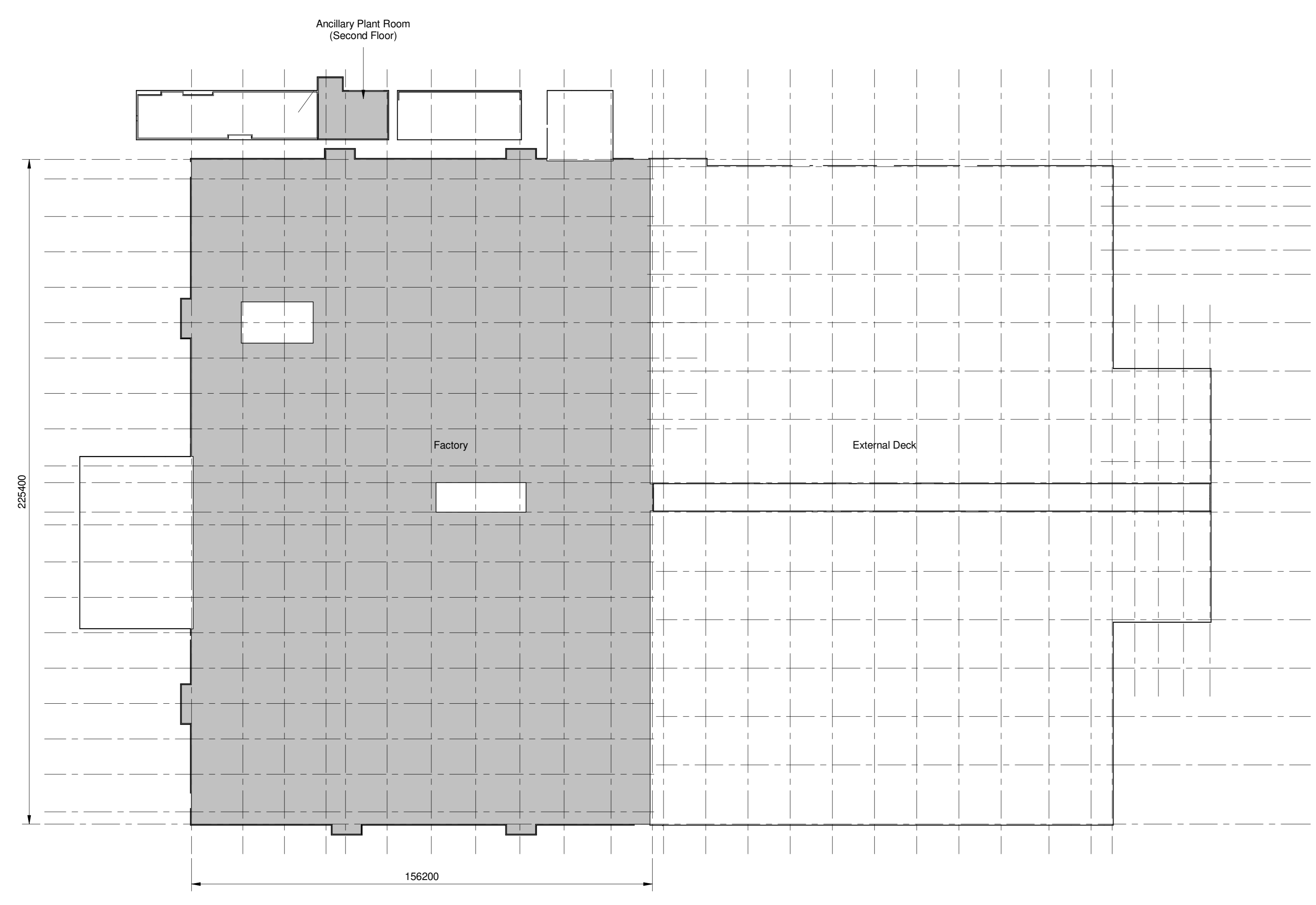

**First Floor**  
 1 : 1000

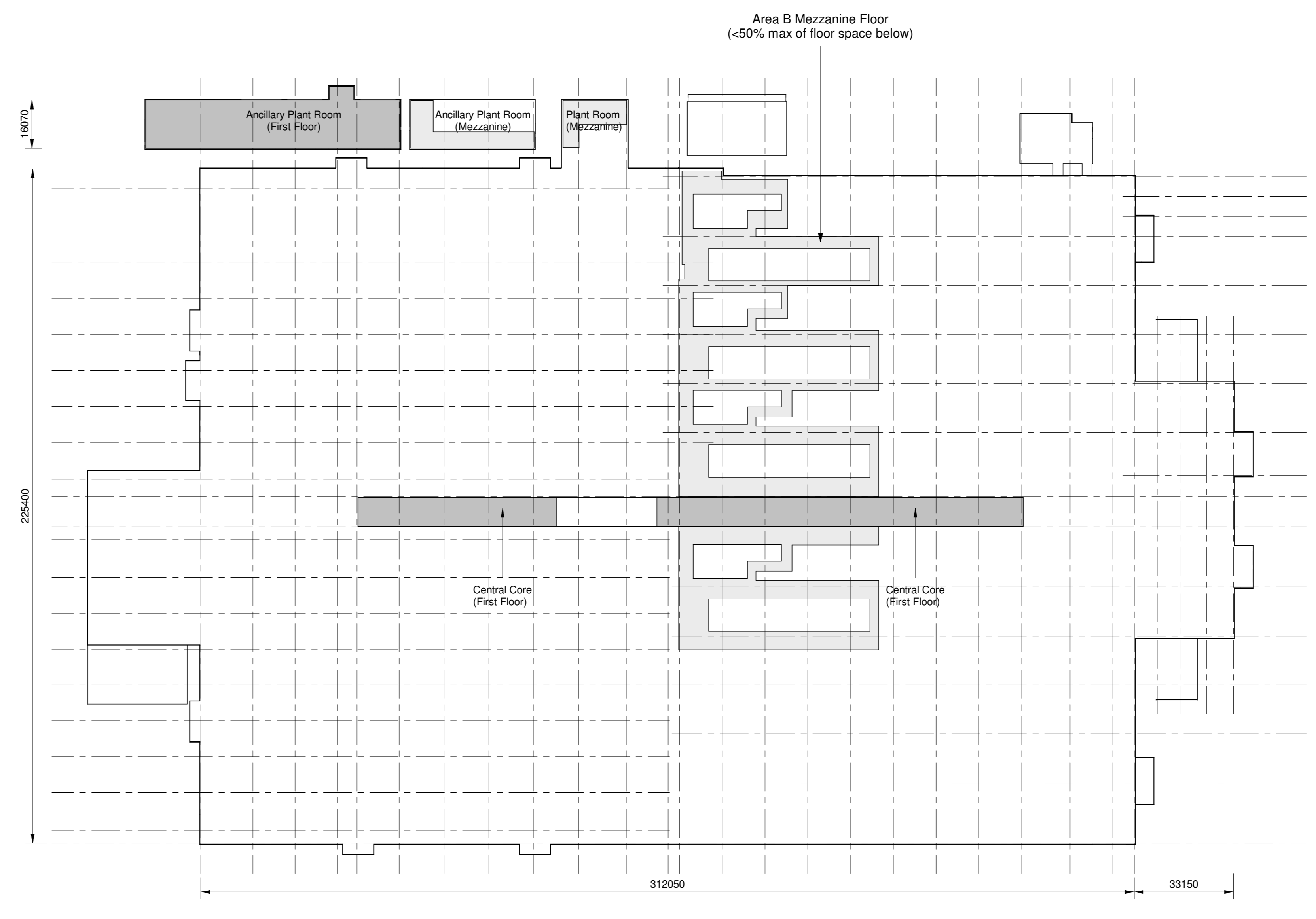

**Mezzanine Level**  
 1 : 1000

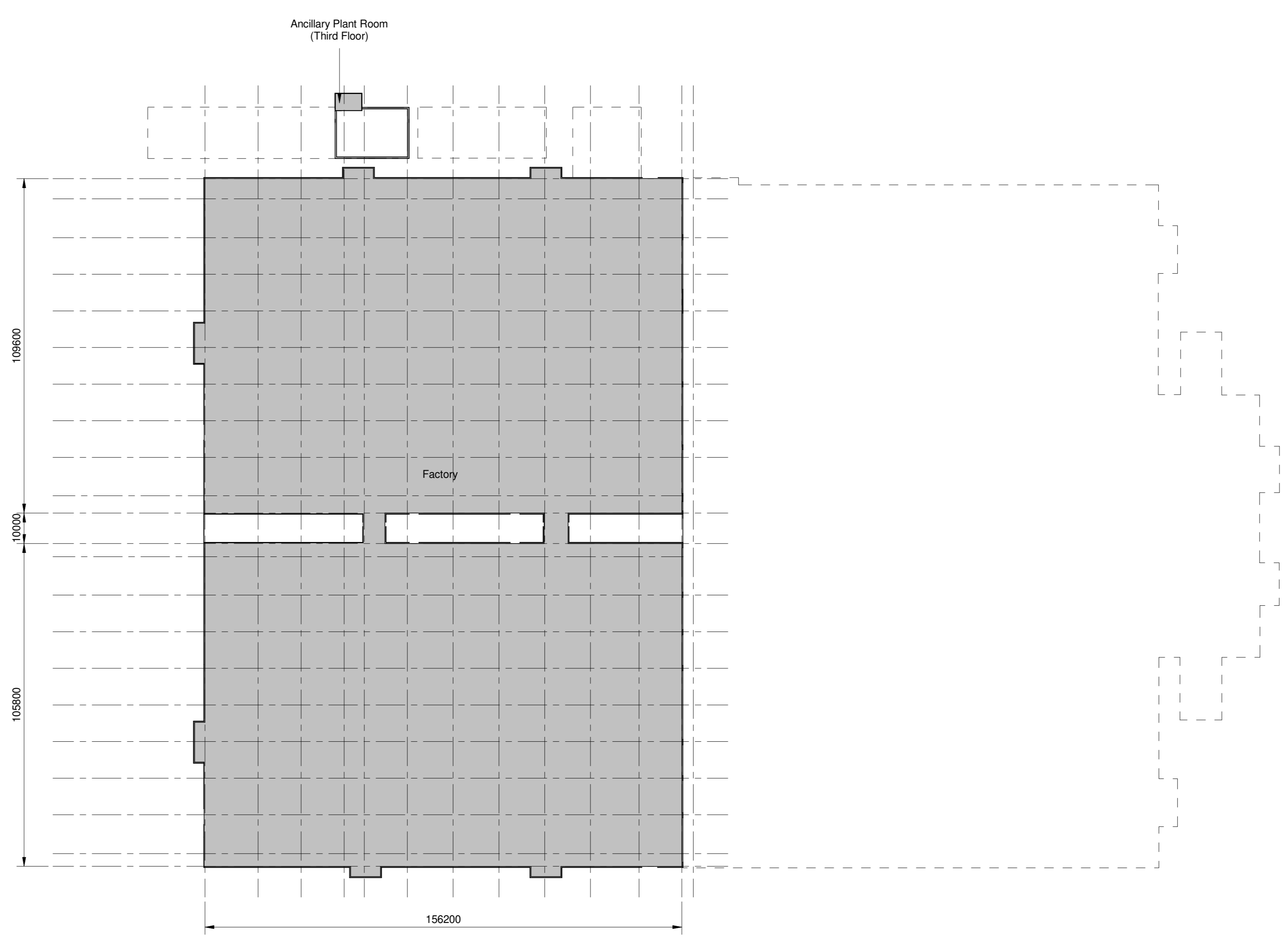

**Second Floor**  
 1 : 1000



P03 Planning Submission	144 JAY 12/05/23
Rev Description	By CxI Date

**RPS** MAKING COMPLEX EASY  
 A TETRA TECH COMPANY  
 Sherwood House, Sherwood Avenue, Newark, Nottinghamshire, NG24 1QG  
 T: 01636 600 700 E: rps@rpsgroup.com

Client: **Envision AESC Wates**  
 Project: **Envision AESC Giga Factory**

Title: **Proposed Factory Plans**

RPS Project Number	Scale @A0	Date Created
NK020439P	1 : 1000	14/07/21
Task Team Manager	Information Author	Task Information Manager
TH	TSR	TSR
Status		
S4 (Suitable for Approval)		
Document Number		Revision
106		P03
Document Number		
rpsgroup.com		